



Symbol photo

**General:**

- Material: PVC-U / PP
- Strainer: PP
- Sealing material: EPDM / FPM
- Dimensions: DN10 – DN80  
d16 – d110  
3/8" – 4"

**Connector types**

**PVC**

- Solvent socket DIN / ASTM / JIS
- Solvent spigot DIN
- Threaded socket BSP
- PE fusion spigot DIN

**PP**

- Fusions socket DIN
- Fusion spigot DIN
- Threaded socket BSP

Further connector types on request

**Operating pressure:**

DN10 d16 d3/8" – DN50 d63 2"	PN16/10
DN65 d75 d2 1/2"	PN16/8
DN80 d90 d3"	PN10/6
DN80 d110 d4"	PN6

**Technical features:**

- Maintenance free operation over a long working life
- Service friendliness
- Radial installation or removal
- Quick and exact closing and opening
- Opening pressure 0,025 bar

This document does not constitute a guarantee, it is for initial information purposes only. The product range is continually upgraded, the designs and types therefore only reflect the state of the art at the time of printing.  
Subject to technical modifications!

# Foot valve S4



## Dimensions:

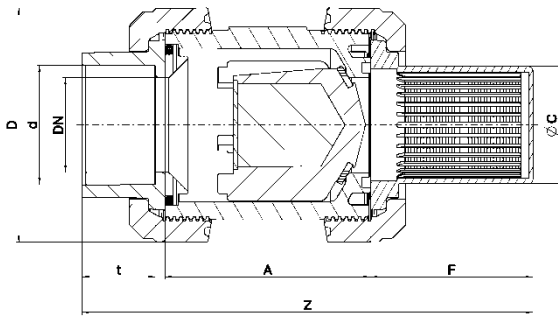

foot valve with solvent socket

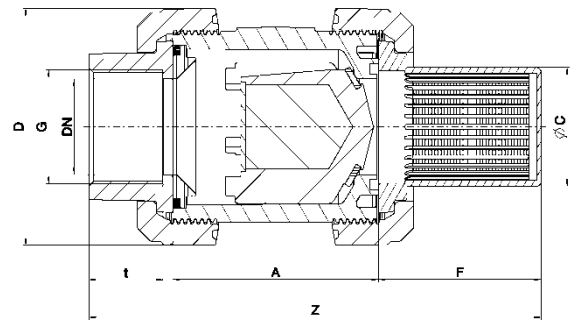

foot valve with threaded socket

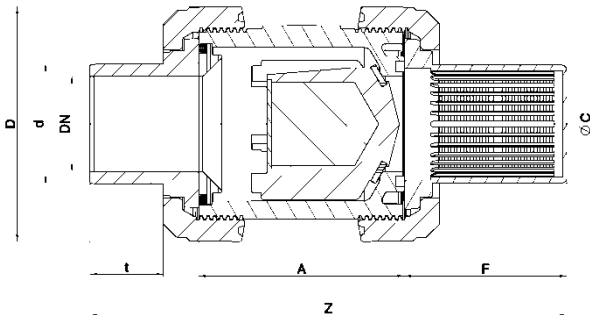

foot valve with solvent spigot

## PVC

### Connector types

PVC solvent socket / threaded socket / solvent spigot

DN	10	15	20	25	32	40	50	65	80	80
d	16	20	25	32	40	50	63	75	90	110
G <sup>TSO</sup> <sup>1</sup>	3/8"	1/2"	3/4"	1"	1 1/4"	1 1/2"	2"	2 1/2"	3"	-
A	62	62	70	74	84	95	109	137	163	163
C	5,8	5,8	6	6,1	7	7,5	8,5	10,5	13,6	13,6
D	53	53	63	70	85	101	124,5	155	188	188
F	49	49	56	58	72	85	85	108	129	129
t <sup>SSO</sup> <sup>2</sup>	16,5	16,5	19,5	22,5	26,5	31,5	38,5	45	55,5	64
t <sup>SSP</sup> <sup>3</sup>	17	17	20	22,5	26,5	31,5	38,5	45	52	64,5
Z <sup>TSO</sup> <sup>1</sup> <sup>SSO</sup> <sup>2</sup>	130	130	149	157	186	216	238	295	357	361
Z <sup>SSP</sup> <sup>3</sup>	137,5	142,5	164	172,5	201,5	230	251,5	319,5	360,5	381,5
PN	16	16	16	16	16	16	16	16	10	6

dimensions in mm

<sup>1</sup> TSO = threaded socket

<sup>2</sup> SSO = solvent socket

<sup>3</sup> SSP = Klebestutzen

- = nicht realisiert

# Foot valve S4

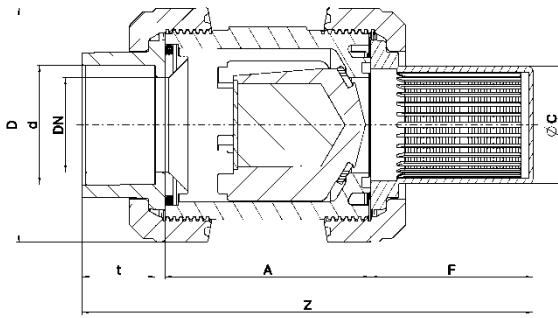

foot valve with fusion socket

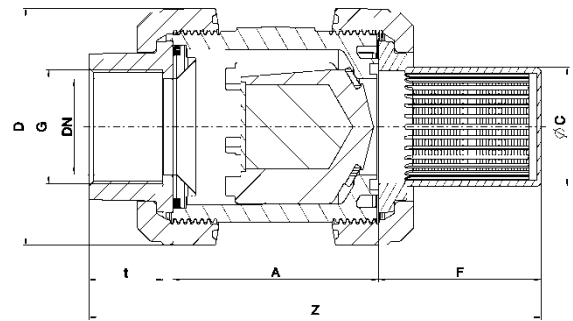

foot valve with threaded socket

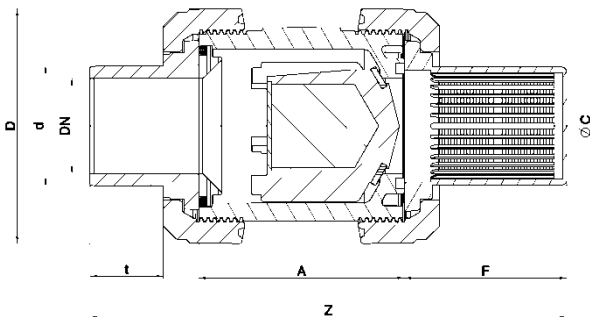

Foot valve with fusion spigot

## PP

### Connector types

PP fusion socket / fusion spigot / threaded socket

DN	10	15	20	25	32	40	50	65	80	80
d	16	20	25	32	40	50	63	75	90	110
G <sup>1</sup> TSO	3/8"	1/2"	3/4"	1"	1 1/4"	1 1/2"	2"	2 1/2"	3"	-
A	62	62	69	73	83	94	108	133	160	160
C	5,8	5,8	6	6,1	7	7,5	8,5	10,5	13,6	13,6
D	53	53	64	71	84,5	100	120,5	155	187	187
F	49	49	56	58	72	85	85	108	129	129
t <sup>2</sup> FSO	14,5	16	17,5	19,5	22	25,5	29	34,5	38,5	42
t <sup>3</sup> FSP	13	14	15,5	18,5	20,5	23,5	28	31	36	38
Z <sup>1</sup> FSO <sup>2</sup>	130	130	147	156	194	214	236	290	353	357
Z <sup>3</sup> FSP	137	142	162	170	209	228	249	313	356	365
PN	10	10	10	10	10	10	10	8	6	6

Dimensions in mm

<sup>1</sup> TSO= threaded socket  
- = not realised

<sup>2</sup> FSO = fusion socket

<sup>3</sup> FSP = Fusion spigot

## Foot valve S4

### Exploded drawing:

01. Body
02. Flat gasket
03. Cone
04. Thrust collar
05. O-Ring
06. Connector types  
 Solvent socket  
 Solvent spigot  
 threaded socket  
 fusion socket  
 fusion spigot
07. Union nut
08. Strainer

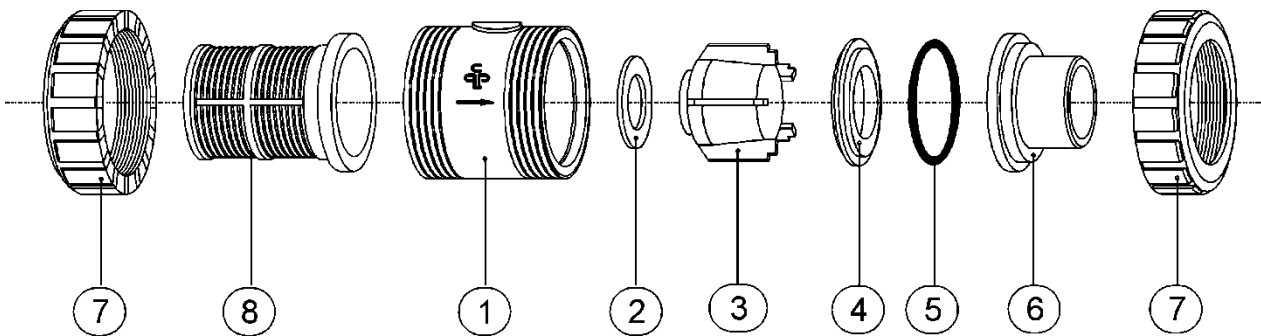

### Diagrams

#### Pressure – Temperature – Diagram

##### PVC

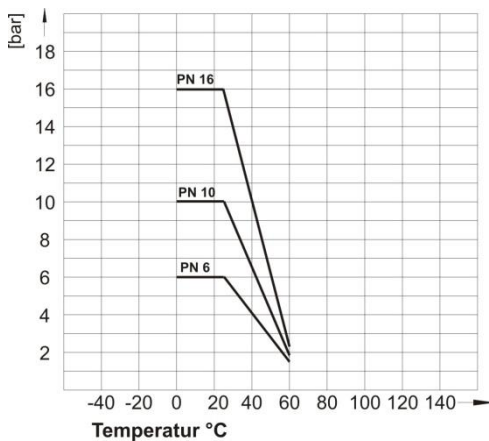

##### PP

